

Cod. 774042 	Cod. 774050
Cod. 886064 	Cod. 774054
Cod. 774044 	Cod. 776082
Cod. 774055 	Cod. 774037
	Cod. 774043

Art. 0912/SH

Art. 0912/H

Art. 0912/2H

Art. 0912/3H

Art. 0912/4H

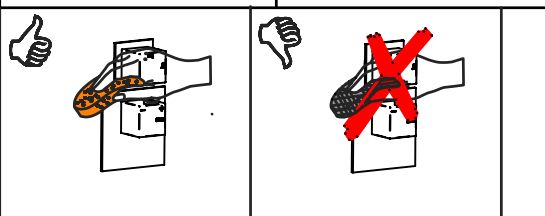
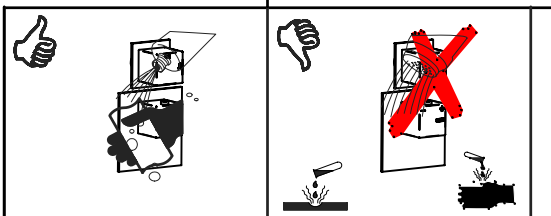

MANUTENZIONE E PULIZIA
Per una corretta manutenzione e pulizia di questo prodotto, raccomandiamo alcuni semplici accorgimenti:

- Utilizzare detergenti neutri, spruzzando il prodotto direttamente su un panno morbido onde evitare infiltrazioni
- Evitare sempre il contatto con prodotti acidi o abrasivi
- Risciacquare bene con abbondante acqua per eliminare eventuali residui ed asciugare sempre con un panno morbido
- Effettuare una pulizia periodica al fine di prevenire le formazioni calcaree

La BELLOSTA CARLO & C. non è RESPONSABILE di danni derivati dall'utilizzo di prodotti impropri per la pulizia.

MAINTENANCE AND CLEANING
For a proper maintenance and cleaning, we recommend the following:

- Use **neutral detergents**, avoiding to spray directly on taps to avoid residual infiltration
- **Avoid** contact with acid or abrasive products
- **Rinse** with water and **always dry** with a clean cloth to avoid residue of detergent
- Perform a **periodic cleaning** to prevent limestone deposits

BELLOSTA CARLO & C. cannot be held responsible for damages due to an improper use of detergents

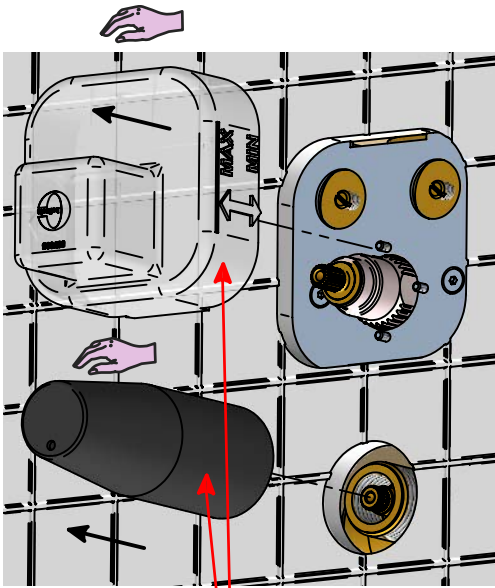

3!

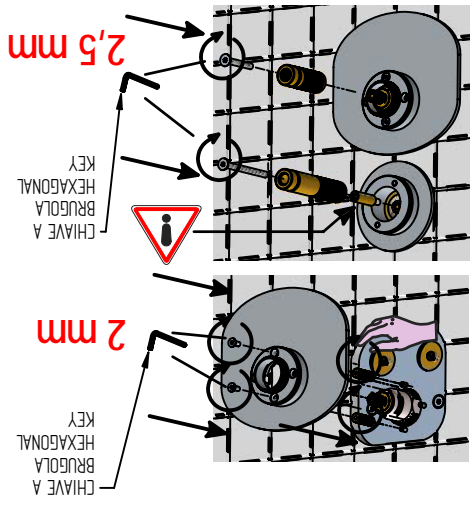

N° INTAGLI DA TAGLIARE
ALLE ASTE BROCCATE
NUMBERS OF NOTCH TO BE
CUT FROM BROACHING ROD
 $N = (X - 27) / 3$



2
RIMUOVERE PELLICOLA DALLA
GUARNIZIONE BIADESIVA
TAKE OFF FROM THE GASKET
THE BY-ADHESIVE FILM

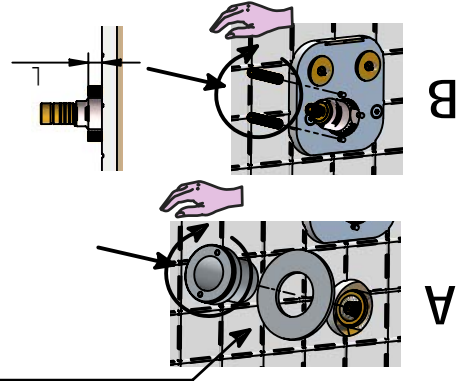

N° INTAGLI DA TAGLIARE AL
DISTENSALE
NUMBERS OF NOTCH TO BE
CUT FROM SLEEVE
 $N_1 = L - 9$

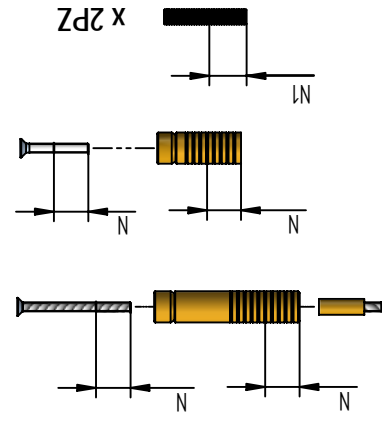

4
TAGLIARE ASTE BROCCATE
E VITI
CUT BROACHING RODS AND
SCREWS

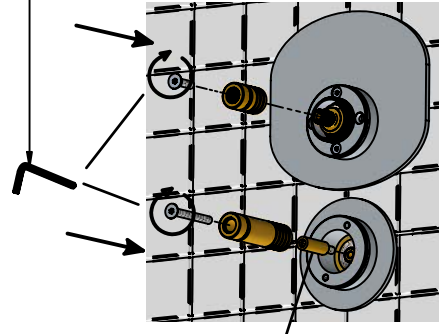

5
CHIAVE A
BRUGOLA
HEXAGONAL
KEY
2,5mm

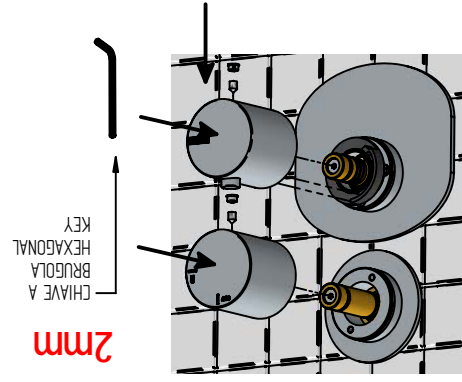

7
CHIAVE A
BRUGOLA
HEXAGONAL
KEY
2mm

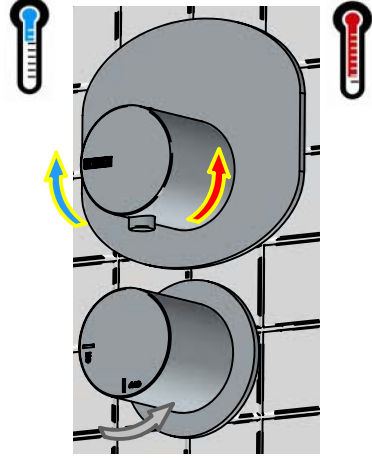
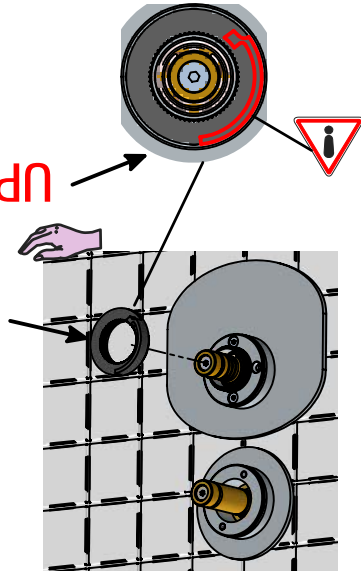

8!